

The Osborn

3 Bedroom Home | Plots: 7, 8, 10, 17, 22-25, 28, 29, 31, 32,
35, 36, 58, 59 & 61-66 | 79m² / 847ft²

BRYN ONNEN
CLYDACH



poblliving
brynonnen@poblliving.co.uk
www.poblliving.co.uk

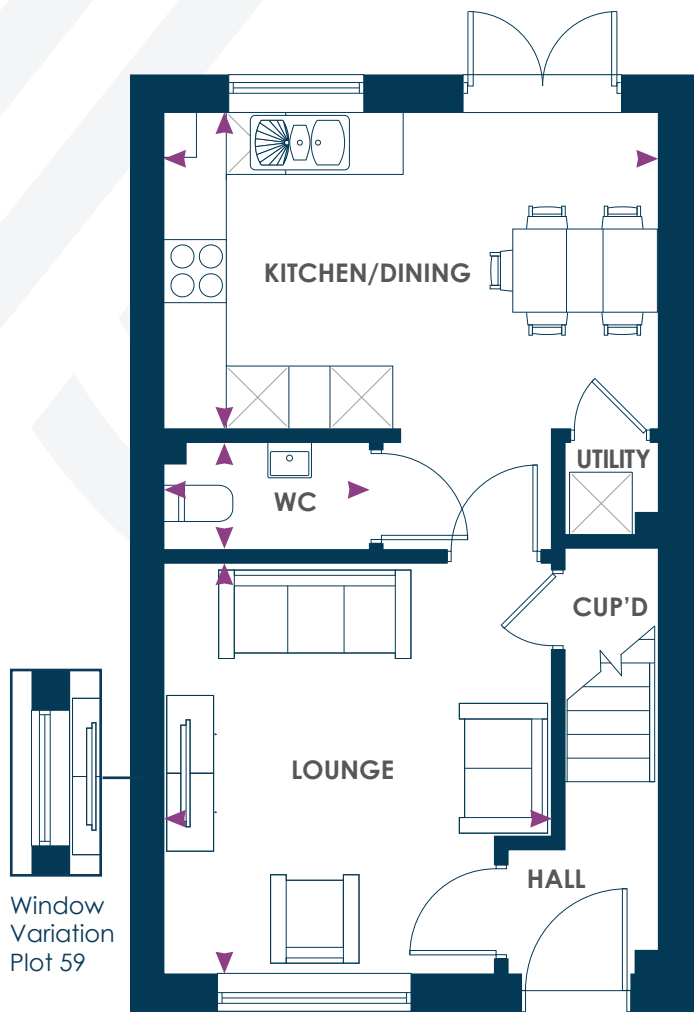

GROUND FLOOR

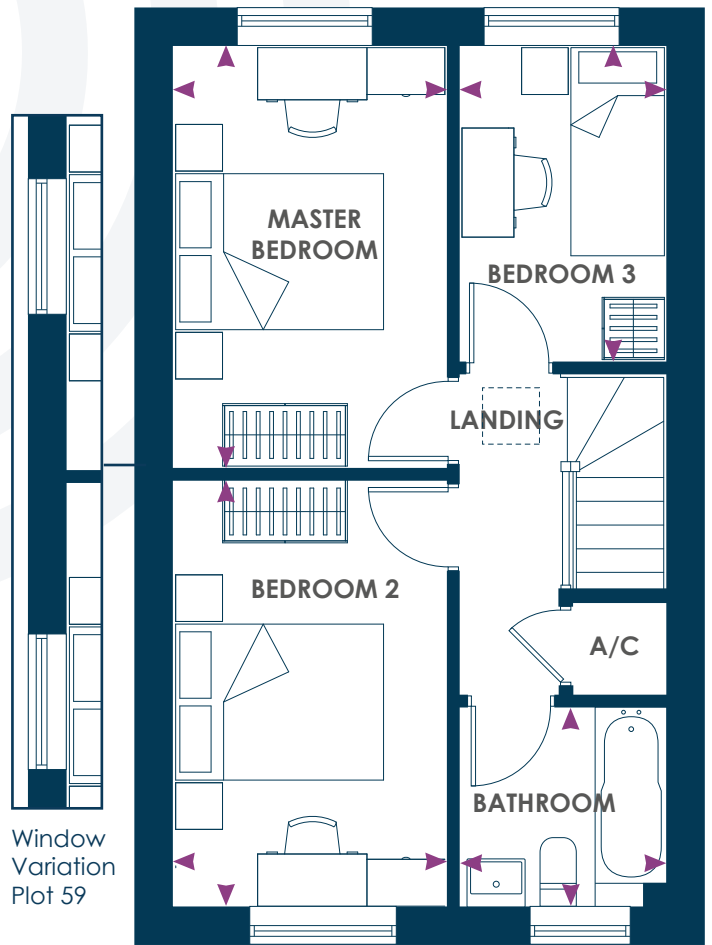

FIRST FLOOR

Plot 59: Furniture layouts in the lounge, bedroom 1 & bedroom 2 vary from this floorplan. Please speak to a Sales Negotiator for more details.

The Osborn

3 Bedroom Home

Plots: 7, 8, 10, 17, 22-25, 28, 29, 31, 32, 35, 36, 58, 59 & 61-66

79m² / 847ft²

GROUND FLOOR

Kitchen/Dining

4.76m x 3.04m 15'6" x 10'0"

Lounge

3.94m x 3.69m* 12'9" x 12'1"

WC

1.98m x 1.05m 6'5" x 3'4"

FIRST FLOOR

Master Bedroom

2.62m x 4.07m 8'6" x 13'4"

Bedroom 2

2.62m x 4.07m 8'6" x 13'4"

Bedroom 3

2.02m x 3.04m 6'6" x 10'0"

Bathroom

2.02m x 1.90m 6'6" x 6'2"