



The Rhiwbina

2 Bedroom Home

Living Area: 63.1m² | 680ft²

CGIs are indicative only and are subject to change, elevations may vary.

woodlandgrove@poblliving.co.uk | www.poblliving.co.uk

The Rhiwbina

2 Bedroom Home

Living Area: 63.1m² | 680ft²

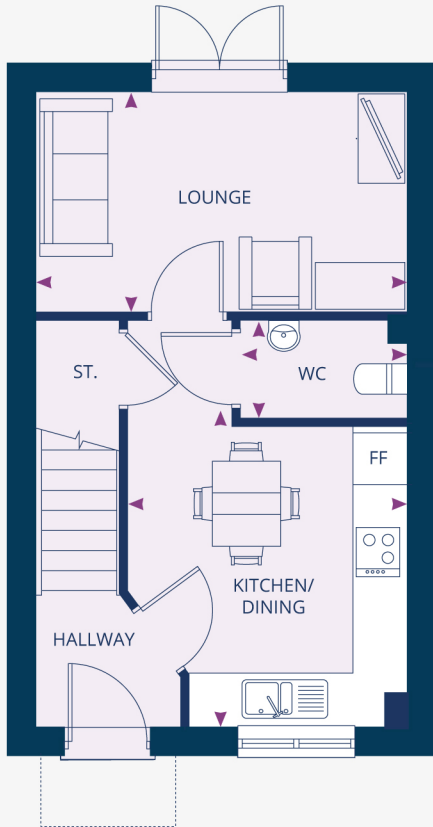

GROUND FLOOR

Kitchen/Dining
3.28m* x 3.76m*

10'9" x 12'0"

Lounge
4.36m x 2.59m

14'4" x 8'6"

WC
1.97m x 1.15m

6'6" x 3'9"

Window variation

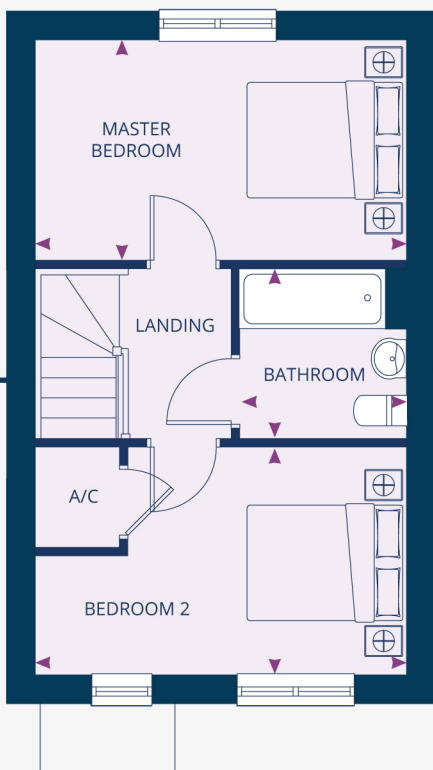

FIRST FLOOR

Master Bedroom
4.36m x 2.59m

14'4" x 8'6"

Bedroom 2
4.36m* x 2.67m*

14'4" x 8'9"

Bathroom
1.97m x 2.00m

6'6" x 6'7"

Window variation

Dimensions stated are within 50mm (2") but should not be used as a basis for furnishings, furniture or appliance spaces etc.

*Dimensions listed are a maximum.

Please note the handing of plots may vary from the plans shown. Please check individual plot details with our sales team.