

TOWELRADS PISA LADDER RANGE



High Heat Output achieved by using 25mm bars.

Versatile, can be used on central heating or dual fuel systems.

For the full and extensive range of towel rails, elements and accessories please visit our website at www.towelrads.com.

Curved options available in white and chrome variants.

Max Working Pressure: 10 bar

Max Working Temp: 110 degrees C



Manufacturers
Warranty



Available in Chrome,
White, Black & Anthracite



FEATURES AND BENEFITS

- Classic ladder towel radiator for stylish, contemporary bathrooms
- Wide range of heights, widths and finishes available to suit any space
- 25mm bars give much better heat output than standard towel radiators with 19mm and 22mm tubes
- Curved towel radiators also available in this range
- An even higher output can be achieved by opting for one of our popular modern painted finishes
- Horizontal models also available to fit neatly under windows
- Can be connected to central heating or used with a dual fuel element for versatility
- Plenty of towel warming space

PISA WHITE STRAIGHT

Height	Length	Product Code	Pipe Centres	Output at ΔT_{50k}	
				Watts	BTU
800	400	160001	355	316	1078
	450	160002	405	349	1191
	500	160003	455	383	1307
	600	160004	555	451	1539
1200	400	160005	355	471	1607
	450	160006	405	522	1781
	500	160007	455	572	1952
	600	160008	555	673	2296
1500	400	160009	355	592	2020
	450	160010	405	655	2235
	500	160011	455	718	2450
	600	160012	555	845	2883
1800	400	160013	355	716	2443
	450	160014	405	792	2702
	500	160015	455	869	2965
	600	160016	555	1021	3484

PISA WHITE CURVED

Height	Length	Product Code	Pipe Centres	Output at ΔT_{50k}	
				Watts	BTU
800	400	160017	355	343	1,170
	450	160018	405	386	1,317
	500	160019	455	429	1,464
	600	160020	555	515	1,757
1200	400	160021	355	495	1,689
	450	160022	405	556	1,897
	500	160023	455	618	2,109
	600	160024	555	742	2,532
1500	400	160025	355	626	2,136
	450	160026	405	705	2,406
	500	160027	455	783	2,672
	600	160028	555	940	3,207
1800	400	160029	355	764	2,607
	450	160030	405	859	2,931
	500	160031	455	954	3,255
	600	160032	555	1,145	3,907

PISA BLACK STRAIGHT

Height	Length	Product Code	Pipe Centres	Output at ΔT_{50k}	
				Watts	BTU
800	400	170001	355	316	1078
	500	170002	455	383	1307
	600	170003	555	451	1539
1200	400	170004	355	417	1607
	500	170005	455	572	1952
	600	170006	555	673	2296
1600	400	170007	355	633	2160
	500	170008	455	768	2620
	600	170009	555	903	3081

PISA ANTHRACITE STRAIGHT

Height	Length	Product Code	Projection	Pipe Centres	Weight KG	Water Content L	Output at ΔT_{30k}		Output at ΔT_{50k}		DF Max Imm Rate	n EXPO-NENT
							Watts	BTU	Watts	BTU		
800	400	150001	65-88mm	355	6	3.95	163	555	316	1078	300	1.22
	500	150002	65-88mm	455	71	4.67	197	673	383	1307	400	1.22
	600	150003	65-88mm	555	79	5.39	232	793	451	1539	400	1.22
1200	400	150004	65-88mm	355	9.3	5.59	243	828	417	1607	300	1.23
	500	150005	65-88mm	455	9.95	6.56	295	1005	572	1952	400	1.23
	600	150006	65-88mm	555	10.95	7.53	347	1182	673	2296	400	1.23
1600	400	150007	65-88mm	355	11.65	7.63	326	1112	633	2160	400	1.23
	500	150008	65-88mm	455	12.75	8.98	396	1349	768	2620	600	1.23
	600	150009	65-88mm	555	14.8	10.34	465	1587	903	3081	600	1.23

PISA CHROME STRAIGHT

Height	Length	Product Code	Pipe Centres	Output at ΔT_{50k}	
				Watts	BTU
600	400	140001	355	158	539
	450	140002	405	175	597
	500	140003	455	193	659
	600	140004	555	228	778
800	300	140005	255	161	549
	400	140006	355	207	706
	450	140007	405	230	785
	500	140008	455	253	863
	600	140009	555	298	1017
	750	140010	705	367	1252
1000	400	140011	355	257	877
	500	140012	455	313	1068
	600	140013	555	370	1262
1200	300	140014	255	240	819
	400	140015	355	308	1051
	450	140016	405	342	1167
	500	140017	455	375	1280
	600	140018	550	442	1508
	750	140019	705	543	1853
1400	400	140020	355	361	1232
	450	140021	405	400	1365
	500	140022	455	439	1498
	600	140023	555	517	1764
	750	140024	705	635	2167
1600	300	140025	255	326	1112
	400	140026	355	415	1416
	450	140027	405	460	1570
	500	140028	455	505	1723
	600	140029	555	594	2027
1800	300	140030	255	371	1266
	400	140031	355	472	1610
	450	140032	405	522	1781
	500	140033	455	572	1952
	600	140034	555	673	2296
	750	140035	705	824	2811

PISA CHROME CURVED

Height	Length	Product Code	Pipe Centres	Output at ΔT_{50k}	
				Watts	BTU
600	400	140036	355	182	621
	450	140037	405	205	699
	500	140038	455	228	778
	600	140039	555	273	931
800	400	140040	355	274	935
	450	140041	405	308	1,051
	500	140042	455	342	1,167
	600	140043	555	411	1,402
1000	400	140044	355	321	1,095
	500	140045	455	400	1,365
	600	140046	555	481	1,641
1200	400	140047	355	352	1,201
	450	140048	405	396	1,351
	500	140049	455	440	1,501
	600	140050	550	528	1,802
1400	400	140051	355	426	1,454
	450	140052	405	479	1,634
	500	140053	455	532	1,815
	600	140054	555	639	2,180
1600	400	140055	355	504	1,720
	450	140056	405	569	1,941
	500	140057	455	632	2,156
	600	140058	555	760	2,593
1800	400	140059	355	548	1,870
	450	140060	405	617	2,105
	500	140061	455	686	2,341
	600	140062	555	823	2,808

TECHNICAL DIAGRAMS

PISA LADDER COLLECTION

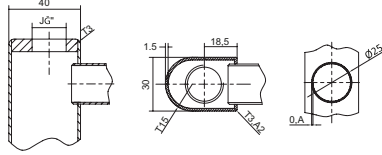

600MM CONFIGURATION

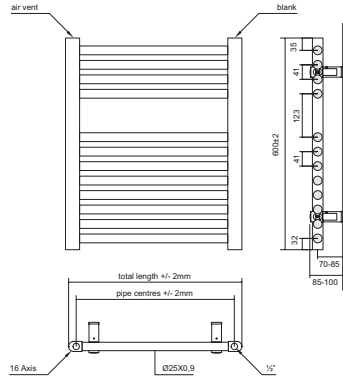

800MM CONFIGURATION

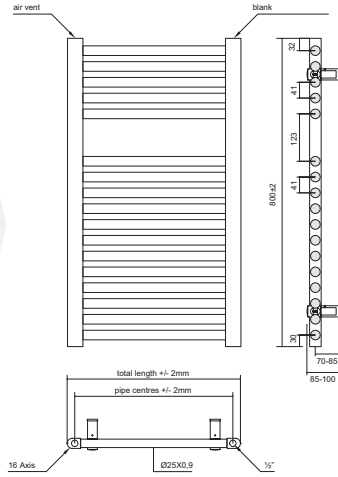

1000MM CONFIGURATION

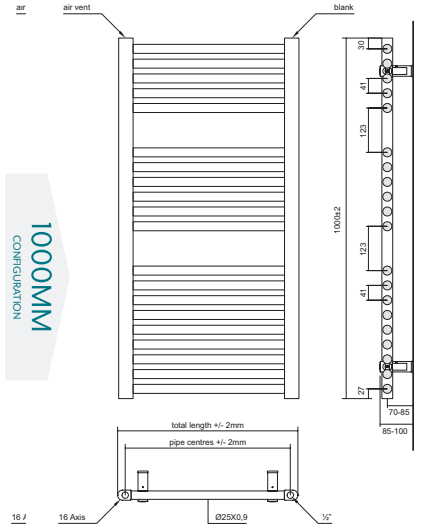

1200MM CONFIGURATION

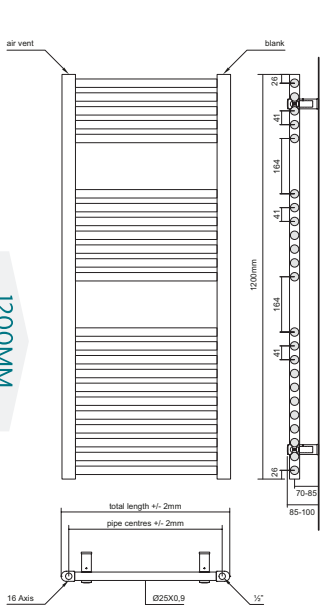

1400MM CONFIGURATION

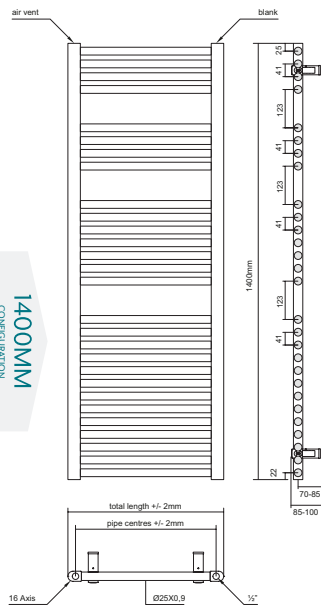

1600MM CONFIGURATION

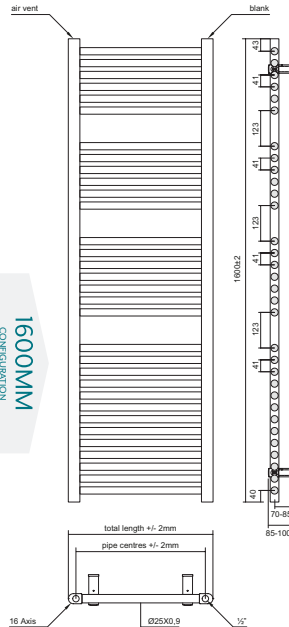

1800MM CONFIGURATION

